

Laurel Park Town Center

Vision for the Town Center & Highway Corridor

Vision





Town Center / Highway 64 Corridor Vision

This is an artist's depiction of the reconfigured US Highway 64 corridor looking east towards Hendersonville. The planned upgrades to the Highway include four new roundabouts, new sidewalks, new bike lanes, new street lights, landscaping, and other improvements. The orange dashed line to the south of the corridor depicts the new Ecusta Trail. The improvement project includes gateway features to help travelers recognize their arrival in Laurel Park. The Town is pursuing additional changes to the areas along the corridor to enhance the pedestrian experience, support connections to the Ecusta Trail, and establish a "living room" or village core for Laurel Park.



**"ROUNABOUT #3"
PISGAH DRIVE**

↑ To Hendersonville



Potential pathway
connecting to the
Ecusta Trail →



Town Center / Highway 64 Corridor Vision

This is an artist's depiction of the Pisgah Drive roundabout (roundabout #3) and its surroundings. The building to the lower left is the Sage Pet Hospital in front of the Ingles shopping center. The area to the right of the roundabout is the former Coats industrial plant site (buildings removed). As depicted in the drawing, Highway 64 has two travel lanes divided by a planted median, new sidewalks, cross walks, bike lanes, street trees, street lights, and other features. This sketch shows a conceptual location of one of many potential walking paths connecting to the Ecusta Trail corridor. The area around Roundabout 3 is the core of the Laurel Park Town Center district and could become the Town's "living room" with walkable mixed-use development and residences.

Ingles
shopping
center

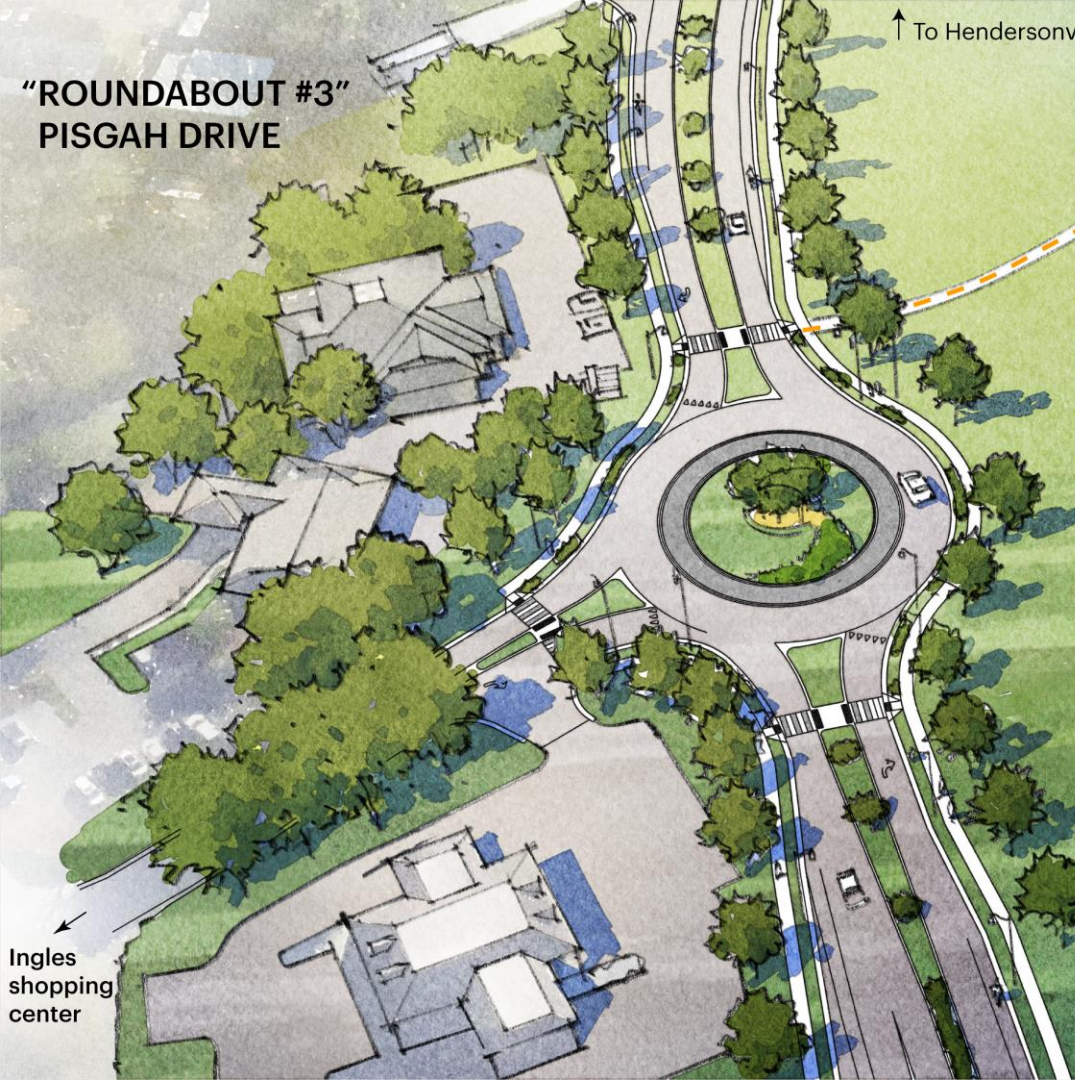



Town Center / Highway 64 Corridor Vision

This is an artist's depiction of the new Highway 64 corridor looking east towards Hendersonville. Buildings are mixed-use, village-scale structures with outdoor dining and gathering areas along the corridor. The area is a vibrant, pedestrian-oriented town center with dwellings, shops, and restaurants.



Town Center / Highway 64 Corridor Vision



This is an artist's depiction of one of the roundabouts. The image shows how buildings are located close to the Highway 64 corridor, how pedestrian areas are located in front of buildings, and parking is to the side or rear. Buildings maintain a mountain village character with earth tones, natural materials, and human-scaled design features. Gathering areas and open spaces are prioritized over parking and utility features.



SPRING

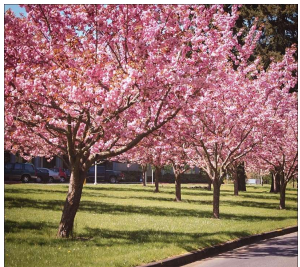
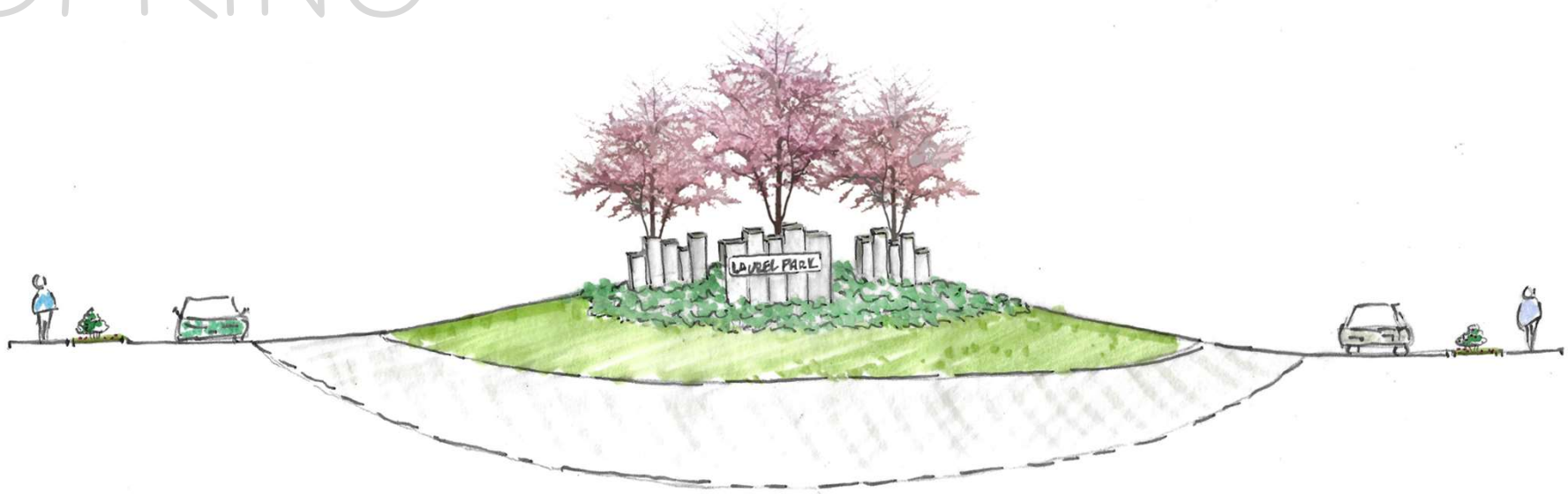

SUMMER

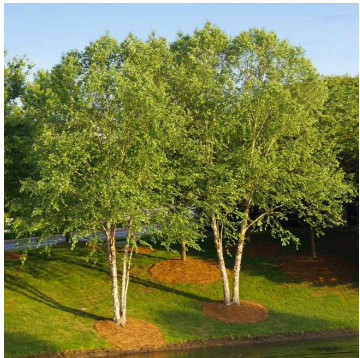

FALL

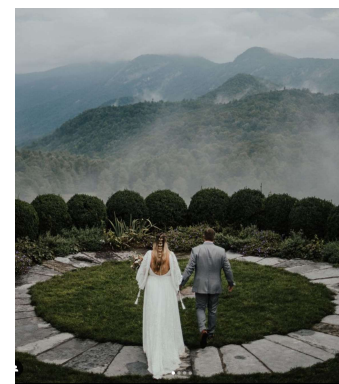
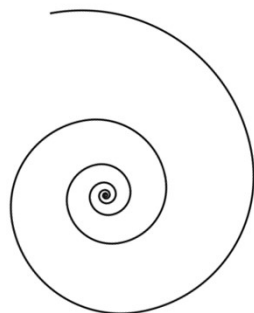
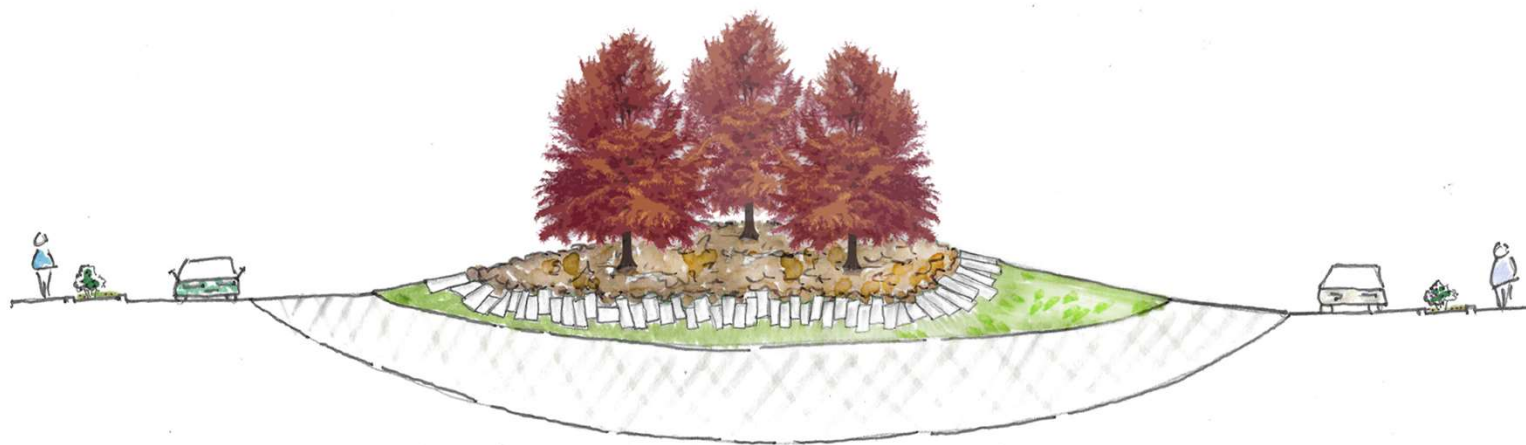

WINTER

